



King Farms, Moriarty, OG.132









Access Type: Hunting.

GMU: 8/ 43

Access Hours: 2 hours before sunrise to 2 hours after sunset.

Information: This property contains 3,306 acres, in 3 separate parcels, located in GMU 8 on the northern outskirts of Moriarty, NM, off Highway 41. This property falls within the Estancia Valley and the acreage consists of a mixture of irrigated croplands and rangeland, which is actively farmed and ranched. Approximately 1,000 acres are cultivated to produce hay and forage silage. Waste grain and crop residue help attract birds and provide them with some food. This makes for good dove hunting and crane hunting in cultivated areas. Scattered stock tanks should provide some additional shooting opportunities for dove hunters when water is available.

Permitted Activities: Hunting is only permitted on this property during the seasons and dates specified in the Open Gate lease agreement between the Department of Game and Fish and the landowner. Access to the property is subject to the terms and conditions in the Open Gate lease agreement and is restricted to the following permitted activities:

Permitted Activity	Available Dates	Remarks
Dove Hunting (Mourning, White-winged and Eurasian Collared Doves, and Band-tailed Pigeon)	 Please see the 2025-2026 Hunting Rules and Information. <i>Page 138: Upland Game</i> <i>Page 141: Migratory Game Birds</i>	Eurasian Collard Doves may only be hunted during open seasons for Mourning and White-winged doves  Refer to <i>Migratory Game Bird Supplement</i>. 
Sandhill Crane Hunting	 Please see the 2025-2026 Hunting Rules and Information. <i>Page 141: Migratory Game Birds</i>	Estancia Valley Hunt Area  Refer to <i>Migratory Game Bird Supplement</i>. 

Open Gate is a program that leases private lands to improve public access for hunting, fishing, and trapping. Open Gate leases are funded exclusively by hunters, anglers, and trappers through the purchase of the Habitat Management and Access Validation (HMAV).

King Farms

Property Rules: The following rules will be posted on this property and enforced at the discretion of the Department of Game and Fish.

- Use of this Open Gate Property is restricted to properly licensed sportspersons for the following activities: **Dove Hunting and Sandhill Crane Hunting (draw hunters only)**.
- Sandhill Crane hunting activities are restricted to draw license hunters only.
- No entry unless you are a properly licensed sportsperson or are accompanied by a properly licensed sportsperson or are license-exempt.
- Each properly licensed sportsperson or license-exempt person is allowed to be accompanied by no more than two guests.
- Scouting is only permitted during the two days immediately preceding the commencement of open season dates.
- No motor vehicle travel off designated roads or parking areas is permitted.
- No destructive acts, including vandalism, graffiti, theft, removal or defacing natural features, resources or signs.
- No target practice.
- No consumption of alcoholic beverages.
- No camping.
- No fires.
- No littering
- Access allowed from two hours before sunrise to two hours after sunset.
- **New Mexico Statute prohibits discharge of a firearm within 150 yards of a dwelling or building without permission of the structure's owner or lessee.**

Rate this Property - NMDGF wants your feedback to ensure that this property is providing an enjoyable outdoor experience. Please take a moment to anonymously rate this property. We know your experience can differ each time you go afield, so be sure to provide a separate review each time you visit this Open Gate property. *After each visit you can quickly provide a review by clicking the **Rate a Property** tab on the [Open Gate homepage](#).*



OPEN GATE
Hunting and Fishing
Access Program

Property OG.132

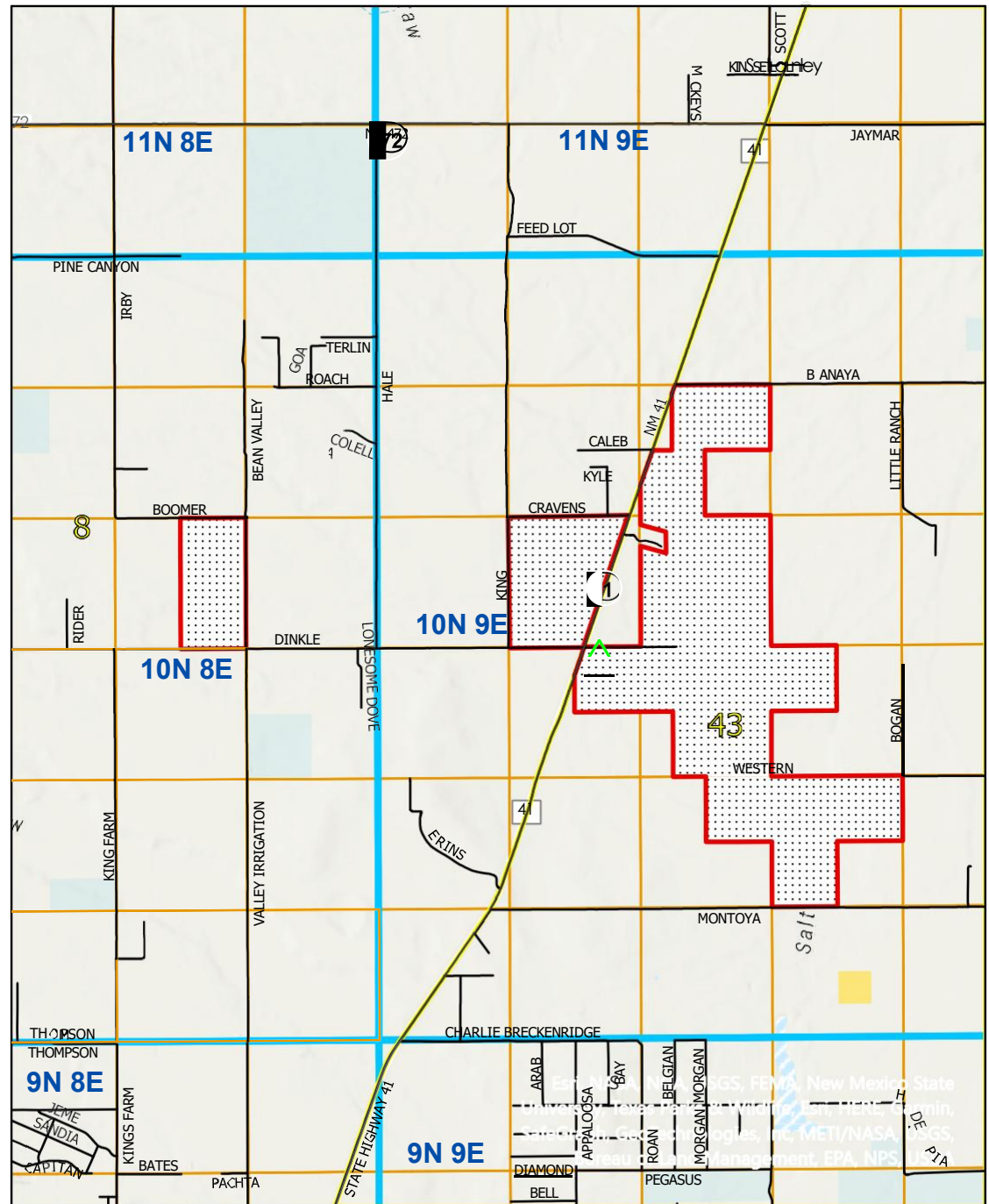
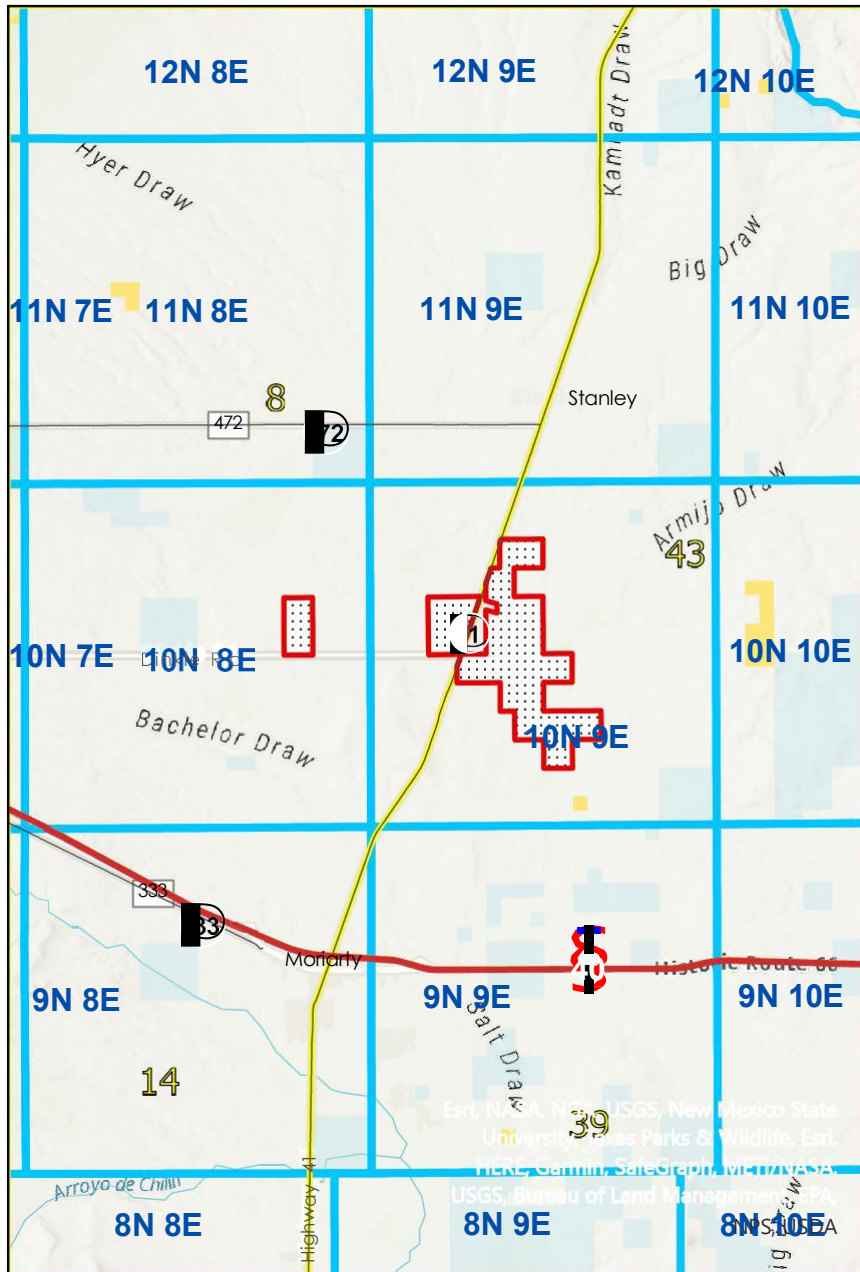

>>> Be Ethical, Courteous, and Safe <<<
All New Mexico Department of Game and Fish
regulations and seasons apply.

- ★ Property Rules Sign
- PLSSTownship
- Open Gate Property
- GMU Boundaries

- Roads
- Secondary Road
 - State Highway
 - Interstate Highway
 - US Highway

- Surface Ownership
- BLM
 - USFS
 - Tribal
 - Private
 - State

